

# How to order ABORA

## Suspension Lighting

Client : \_\_\_\_\_ Project : \_\_\_\_\_

Order # : \_\_\_\_\_ Qty : \_\_\_\_\_ Date : \_\_\_\_\_

### HOW TO ORDER

Example of use **MODEL** - **FINISH** - **CCT** - **SUSPENSION KIT** - **POWER** - **VOLTAGE** - **ELECTRICAL WIRE**  
 ABORA - W - 30K - R3 - 3W - 120 - R

MODEL	FINISH	CCT	SUSPENSION KIT	POWER	VOLTAGE	ELECTRICAL WIRE
<b>ABORA</b>	W = WHITE B = BLACK O = OTHER	30K = 3000K 41K = 4100K	R1 = ROUND 1 FIXTURE SUSP = ROUND 1 FIXTURE R2 = ROUND 2 FIXTURES R3 = ROUND 3 FIXTURES S1 = SQUARE 1 FIXTURE S2 = SQUARE 2 FIXTURES S3 = SQUARE 3 FIXTURES	3W=3W 300LM 6W=6W 600LM	120 = 120VAC non-dimm. 120D = 120VAC dimm. 240 = 240VAC non-dimm.	BW = BLACK & WHITE R = BRAIDED RED W = WHITE C = CLEAR

### Certifications



### Finishes



### Suspension

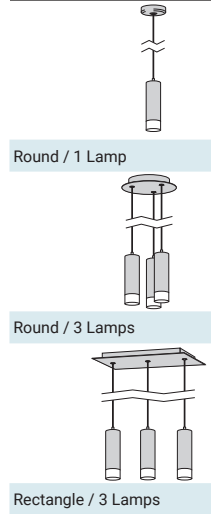

### Electrical Wire

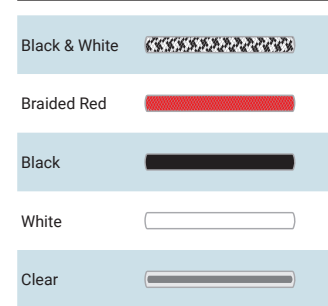

### Features

- Made in North America
- 6063-T5 Aluminum enclosure
- Uniform light distribution with frosted acrylic diffuser
- Power : 3/6 Watts
- Luminous Flux & Power : 300lumens (3W), 600 Lumens (6W)
- Dimmable (use electronic dimmer, e.g. Lutron DVELV-300P)

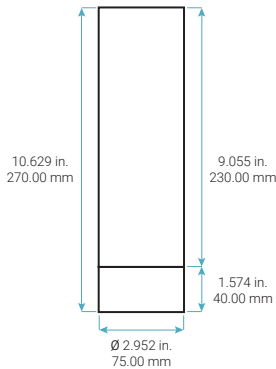

### Light Colour

